

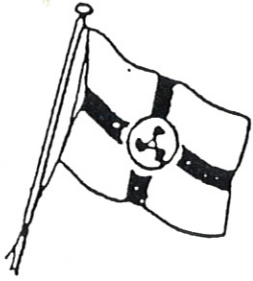

Homologation N°482 Yamaha 50H has been extended to 31st December 2025.



ORIGINAL
Union Internationale Motonautique

Union Internationale Motonautique

Monte Carlo,

Outboard Engine Homologation Sheet No.

00482

International homologation effective from

Homologation valid for the following classes

Manufacturer .. YAMAHA MOTOR CO., LTD

Engine model 50 H

Number manufactured 1500 At the date ..30 /SEP/ 1995

Certified by the National Authority of *Japan*

At the date Signature *Teruaki*

Certified by the U I M *March 22, 1996* At the date

Responsible U I M Homologation Group: Signature

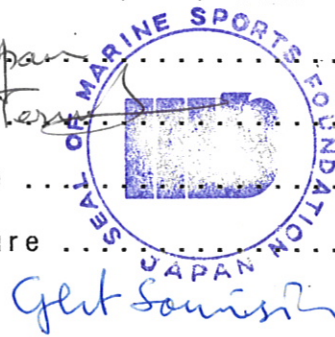

Change specified on page No. Approved at the date. Signature.

.....
.....
.....
.....
.....
.....
.....
.....
.....
.....
.....
.....

00482

ORIGINAL

1.(-12)

Homologation No. Engine model : YAMAHA 50H

Photo of the complete engine, taken 45° from the front side.

Photo of the complete engine, taken 45° from the rear side.



Photo of optional styling, taken 45° from the front side.

Photo of optional styling, taken 45° from the rear side.



Homologation No. 00482

ORIGINAL

1-b. (-12)

Engine model : YAMAHA 50H

Photo of the complete engine,
taken 45° from the front side.

Photo of the complete engine,
taken 45° from the rear side.



Photo of optional styling,
taken 45° from the front side.

Photo of optional styling,
taken 45° from the rear side.



Photo without top cover, taken 45° from the front side.

Photo without top cover, taken 45° from the rear side.

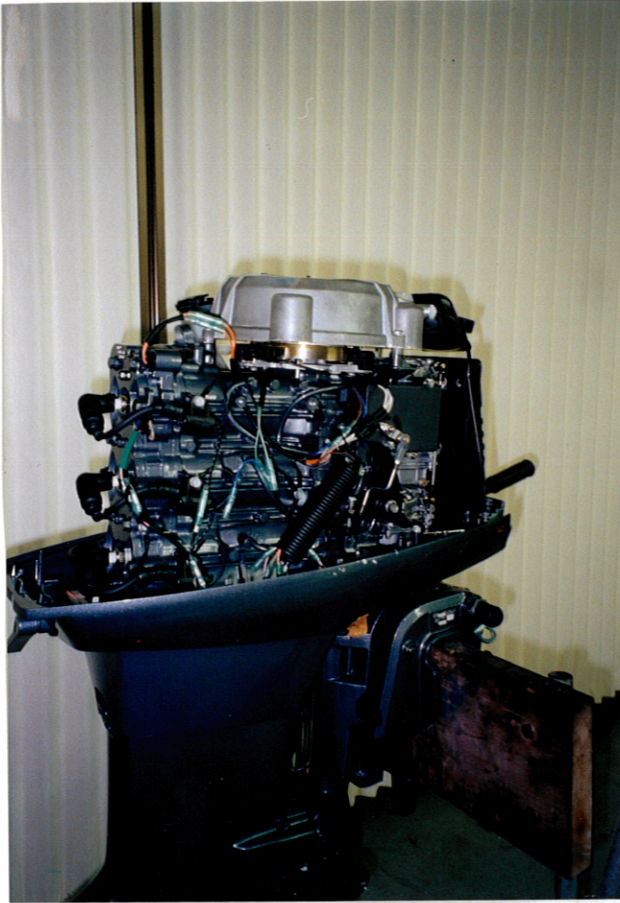
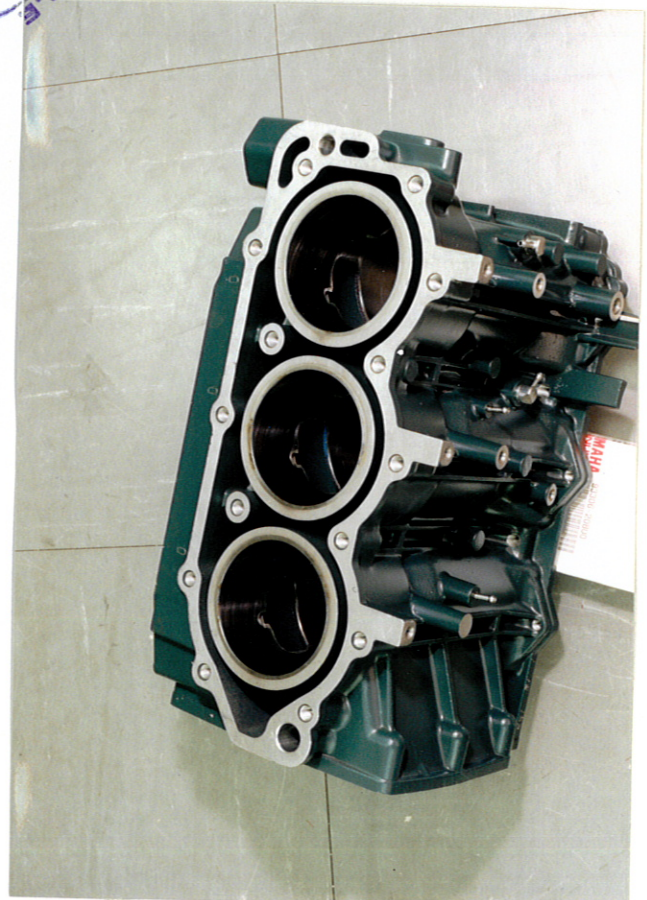
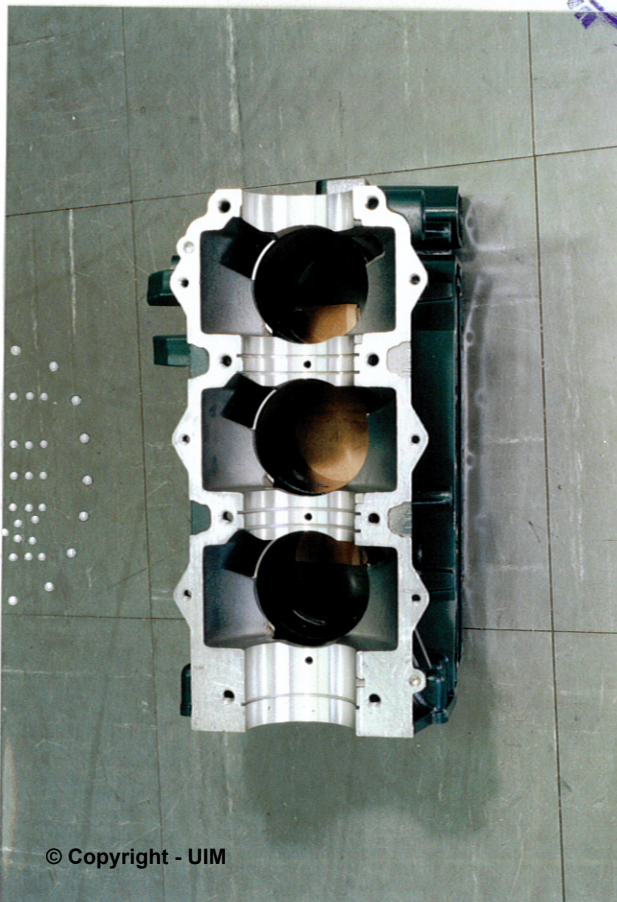

Photo of the cylinder block, from the crank case side showing the transfer ports.

Photo of the cylinder block from the cylinder head flanch showing the exhaust ports.



00482

ORIGINAL

3.(-12)

Homologation No. Engine model : YAMAHA 50H

Photo of the cylinder block, showing the exhaust manifold.

Photo of the crank shaft with connecting rods.

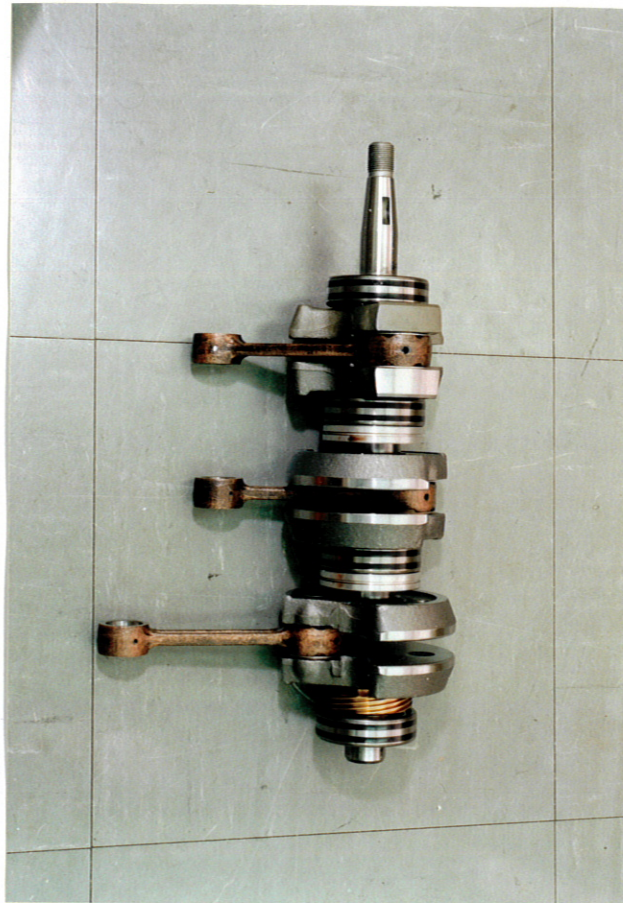
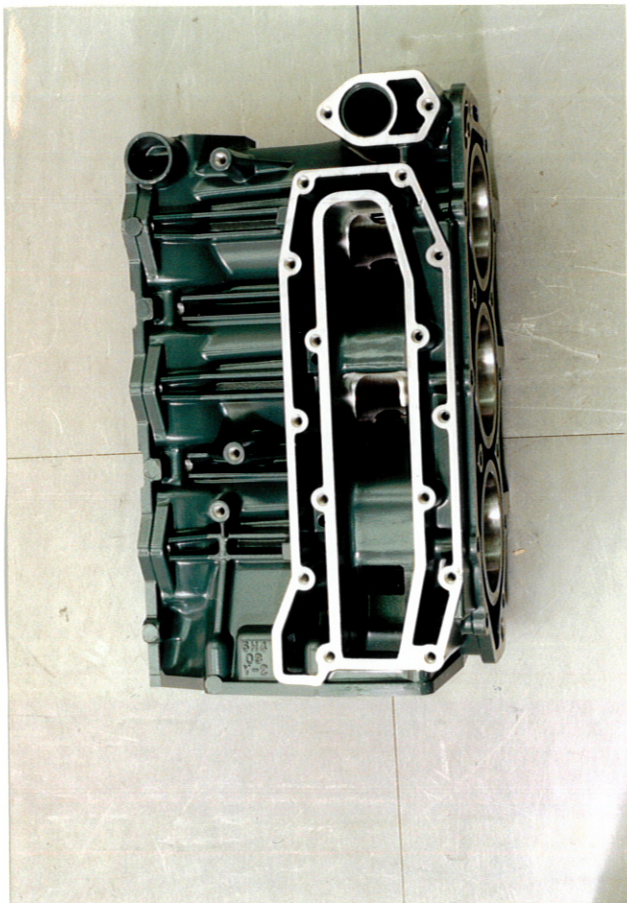

Photo of the piston, taken 45° from the gudgeon pin at the exhaust side.

Photo of the piston, taken 45° from the gudgeon pin at the main boost port side.

UNION INDUSTRIELLE Motonautique



Photo of the piston from the inside.

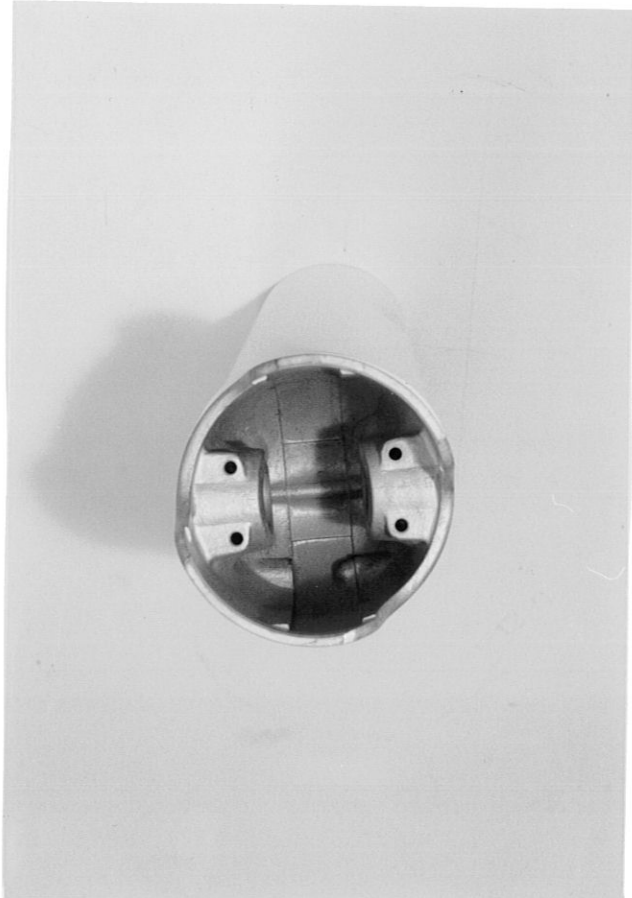

Photo of the combustion chamber.

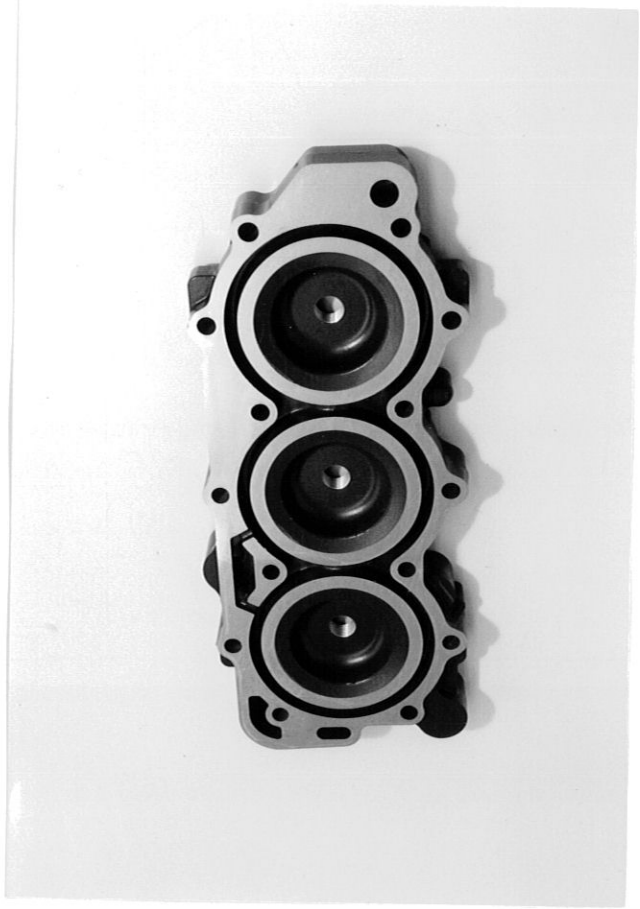

Photo of the air intakes of the intake silencer.



Photo of the internal exhaust pipe.



ORIGINAL 00482



4-b(-12)
YAMAHA 50H

SIZE OF INLET OF AIR INTAKE SILENCER

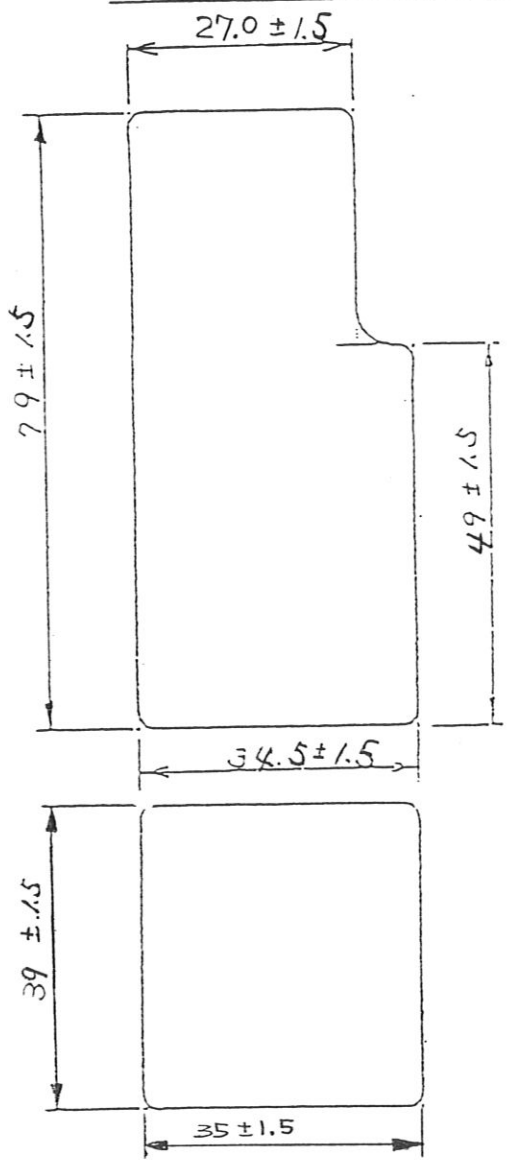

SIZE OF EXHAUST PIPE

OUT LET

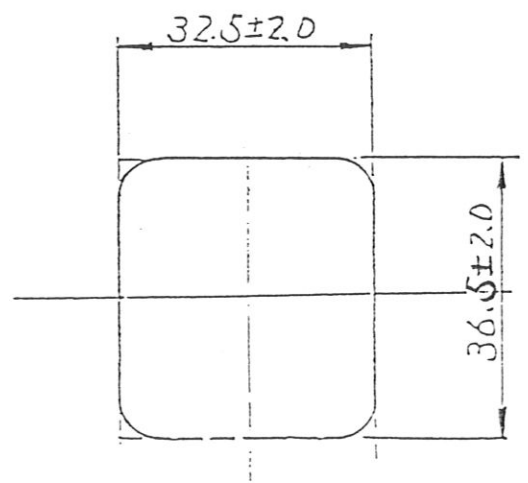

LENGETE

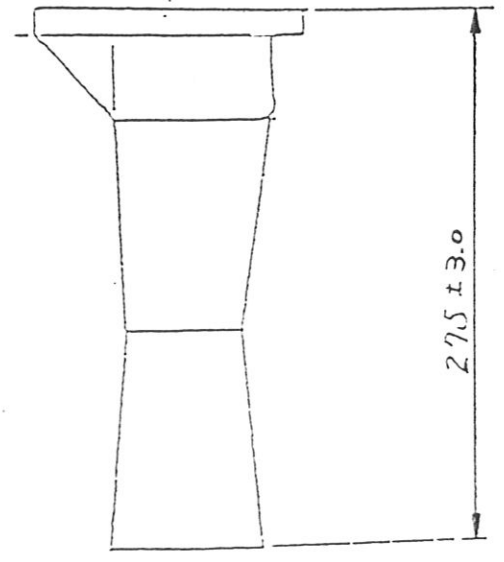



Spread-out sketch of the cylinder-wall with location and dimension measurements of the scavenging ports noted.

Note: Port width dimensions are chordal measurement.

UPPER SURFACE CYLINDER HEAD

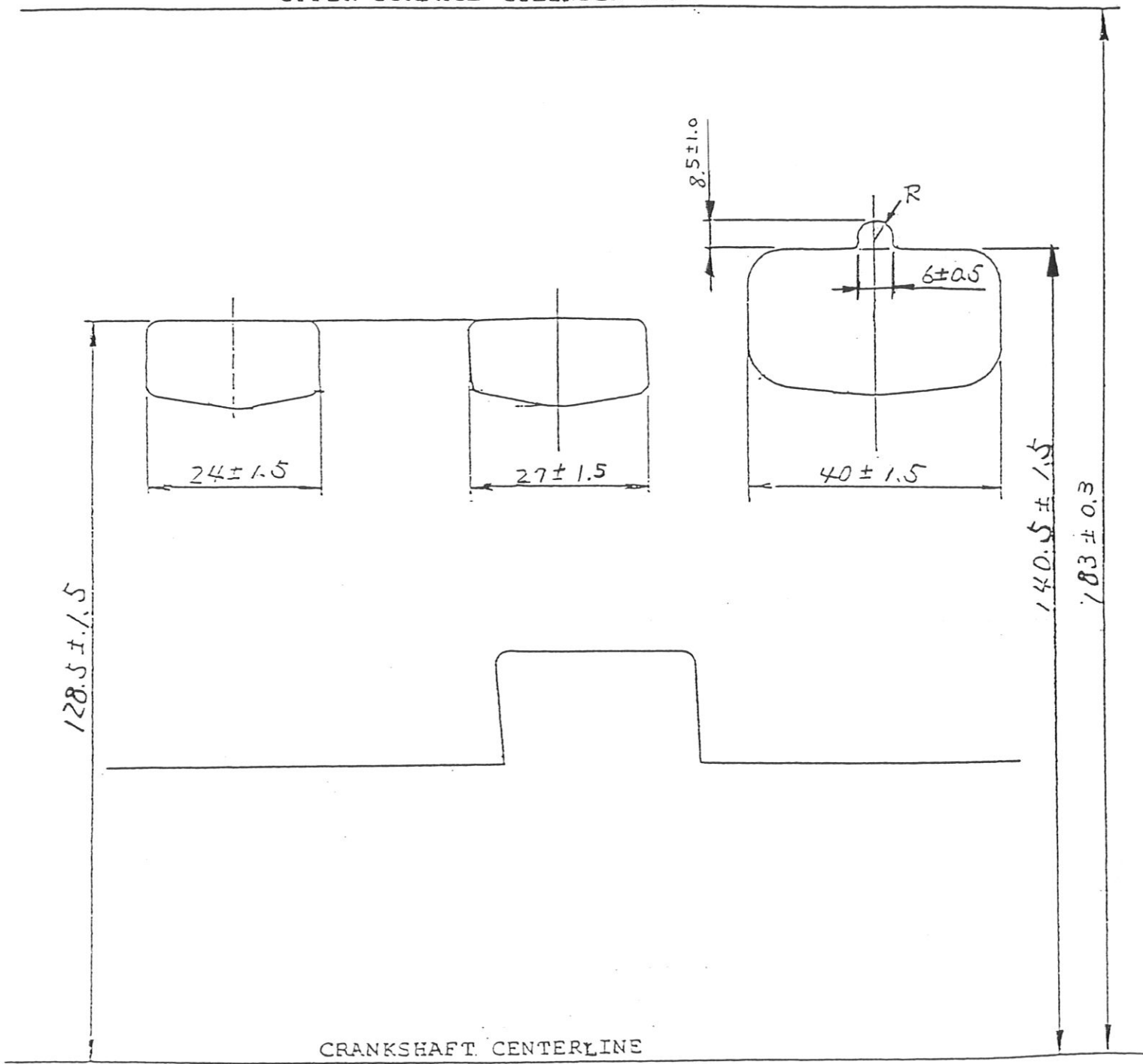

2-stroke outboard engine

ORIGINAL

00482



E. (-12)

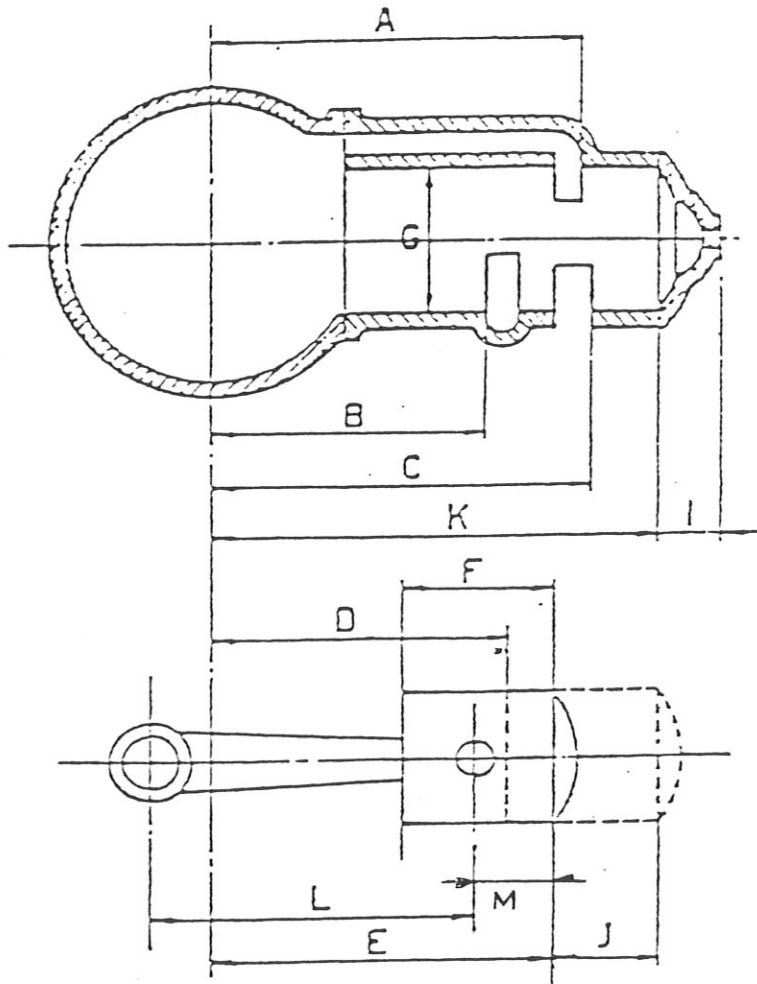

00482

ORIGINAL

7 (-12)

Homologation Manufacturer . YAMAHA

Model 50H

Cycle. 2 STROKE

Number of cylinders . . . 3

Cylinder arrangement . IN LINE

		Tolerances		
ENGINE	G Bore	± 0.1	mm	67
	J Stroke	± 0.2	mm	66
	Capacity per cylinder	nominal	cm ³	233
	Total cylinder capacity	nominal	cm ³	698
	Material of cylinder block			ALUMINUM CASTING
	Material of sleeves			CAST IRON
	Material of cylinder head			ALUMINUM CASTING
	Volume of combustion chamber	minim.	cm ³	29.5
	Combustion chamber minim. volum measured on the engine with the spark plug hole completely <i>filled.</i>			
	Material of piston.			ALUMINUM CASTING
	Number of rings			2
	Ring type and height : 2pcs half keystone . . .	-0.2	mm	2.0
	A Distance from crankshaft centreline of top edge of transfer ports	± 1.5	mm	128.5
	B Distance from crankshaft centreline to lower edge of inlet ports	\pm	mm	NO INLET PORT
	C Distance from crankshaft centreline to top edge of exhaust ports	± 1.5	mm	140.5
	F Hight of piston (less baffle = at port opening corner.)	± 1.0	mm	70
	K Distance from crankshaft centreline to top face of block at centreline of cylinders. . . .	± 0.3	mm	183
	L From big end centreline to crosshead end centreline of connecting rod.	± 0.2	mm	116
M Distance from the gudgeon pin centreline to the top of the piston (= port opening corner) . . .	± 0.3	mm	34	
Number and size of inlet ports 1.0 from cylinder wall	\pm	mm	NO INLET PORT	
Number and size of exhaust ports 1.0 from cylinder wall	± 1.5	mm	1/1CYL 40	
Number and size of transfer ports 1.0 from cylinder wall	± 1.5	mm	3/1CYL. 27 X 2 pcs	
	± 1.5	mm	24 X 1 pc	
see sketch on page 5				

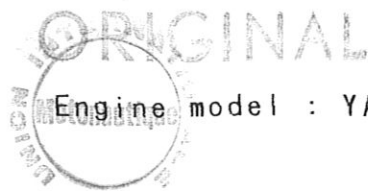

Homologation No.

Engine model : YAMAHA

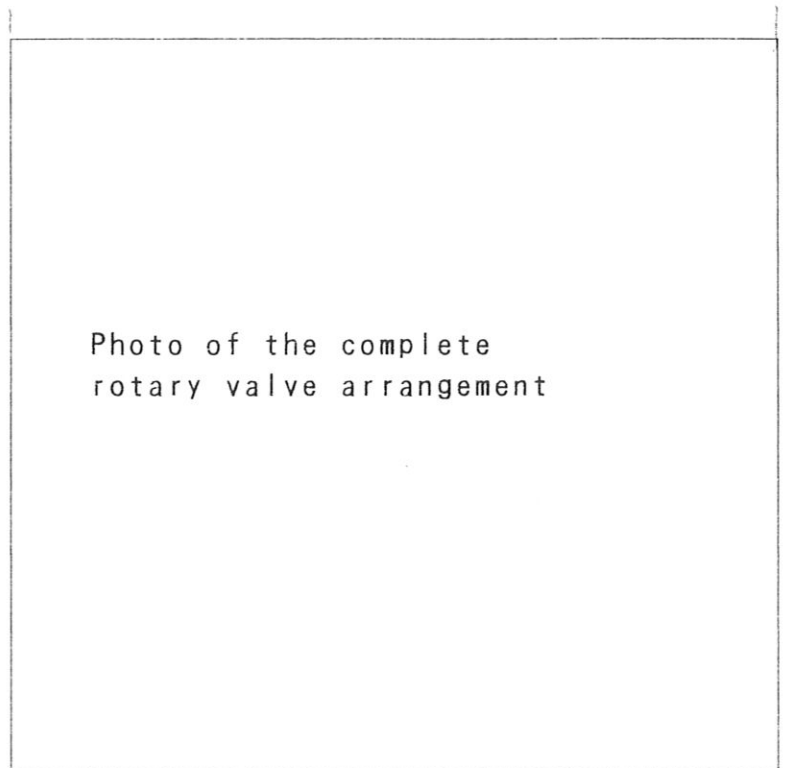
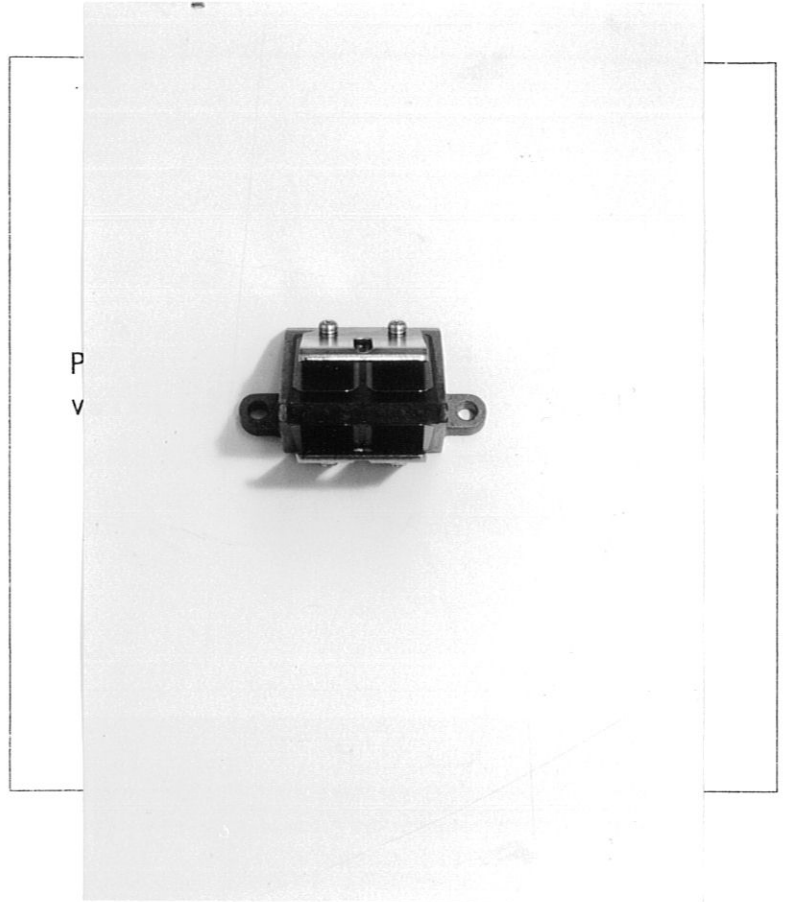
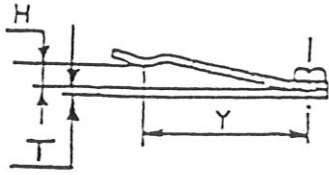

Homologation

Manufacturer . . . YAMAHA . . .

Model 50H

		Tolerances		
Reed valve	T Reed thicknes	±0.1	mm	0.2
	B Lift	±0.5	mm	6.0
	Reed Material			SPECIAL STEEL
	Y Checking distance	±1.0	mm	34
	Number and size of inlet ports Reed valve design, see photo on page 8 (Rubber coated reed housing)	±1.0		4/1 SET 30 X 15/4
Rotary valve	d Diameter of disc.	±		---
	Valve opening time before TDC	± °		---
	Valve closing time after TDC	± °		---
	Dimension of intake opening in cylinder block or crankcase.	±	mm	---
	Rotary valve design , see photo on page 8			---
	valve Material.			---
Weight	Piston with rings , wrist pin and fastenings	minim.	gr	296
	Connecting rod with bearing in both ends and thrust washers.	minim.	gr	NOT POSSIBLE TO MEASURE
	Flywheel with roating attachments	minim.	gr	3730
	Complete crankshaft with seals, bottom bearing. top bearing and centre main bearings.	minim.	gr	7410
Carburettors	Number fitted			3
	Type			BCP 32-26
	Total number of venturis			3
	Diameter of Venturies	±0.5	mm	26
	Diameter of Throttle Housing at butterfly	±0.5	mm	32
	Airintake silencer standard equipment dimension marked on page 4			Yes(X) No
Injection	Make			---
	Type of pump.			---
	Number of injectors			---
	Type of injectors			---
	Number of Throttle Bores & Diameter			---

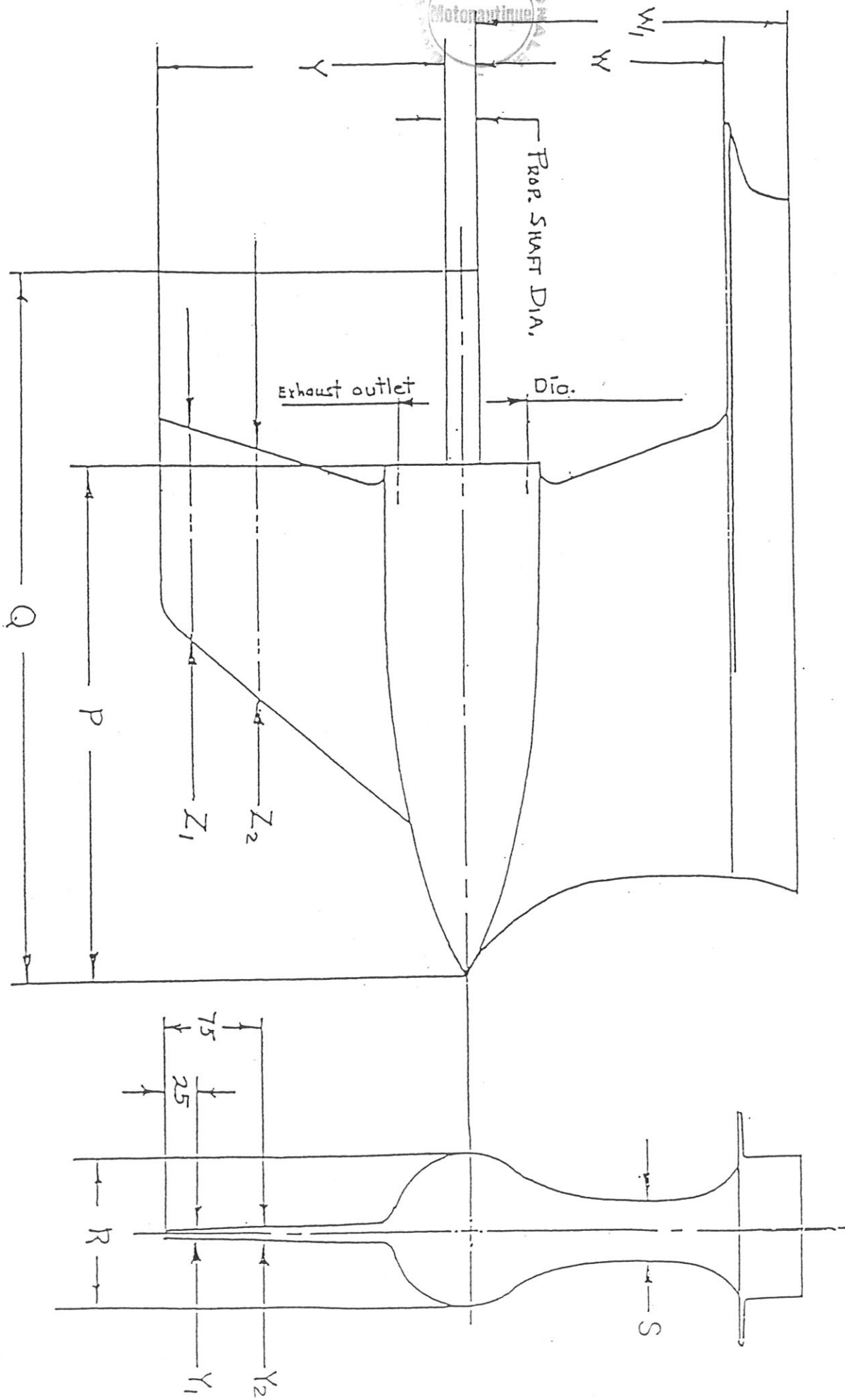

00482

ORIGINAL



11(-12

Homologation

Manufacturer . YAMAHA

Model 50H

		Tolerances		
Ignition	Type			CDI

Cooling	Type			WATER COOL
	Method			WATER PUMP
	Pump.			RUBBER IMPELLER TYPE
Exhaust system	Number of impeller blades			6
	Where are the exhaust outlets located?			PROPELLER BOSS
	Dimension of exhaust outlets.			---
	Exhaust outlet dia. in the rear end of torpedo	±2.0	mm	80
	Internal exhaust pipe standard equipment.			Yes(X) No
	Dimensions marked on the picture page 4			
Supercharger	Type.			---
			
			
Underwater Unit	Gear ratio.			1.85(24/13)
	P Longitudinal length of gear case torpedo.	±5.0	mm	275
	Q Longitudinal dimension of gear case including the propeller shaft	MAXIM.	mm	410
	R Transversal dimension of gear case	±3.0	mm	87
	S Thickness of union leg.	±3.0	mm	39
	Z1 Skeg chord length, 25mm above bottom	±3.0	mm	90
	Z2 Skeg chord length, 75mm above bottom	±3.0	mm	145
	W1 Distance from propeller shaft to upper flange	±5.0	mm	251
	W Distance from propeller shaft to anti-cabitation plate (see sketch page 10)	±5.0	mm	170
	Y1 Thickness of skeg , 25mm above bottom	±1.5	mm	7.0
	Y2 Thickness of skeg , 75mm above bottom	±1.5	mm	8.5
	Y Skeg depth from propeller shaft splines outside dia.	±5.0	mm	158
Dia. of prop. shaft over splines	±1.5	mm	21.5	

00482

ORIGINAL

12(-12

Homologation

Manufacturer . YAMAHA

Model 50H



Power trim	<p>Power trim: Standard model is available.</p> <p>.....</p> <p>.....</p> <p>.....</p> <p>.....</p> <p>.....</p> <p>.....</p>			<p>.....</p> <p>.....</p> <p>.....</p> <p>.....</p> <p>.....</p>
Notes	<p>Notes</p> <ol style="list-style-type: none"> 1. Two kinds of Motor cover decals are available. 2. S-shaft, L-shaft and UL-shaft are available. 3. Manual and electric starting are available. 4. Manual and remote-control steering are available. <p>.....</p> <p>.....</p> <p>.....</p> <p>.....</p> <p>.....</p> <p>.....</p> <p>.....</p>			

2 Stroke outboard engine